

Copyright State of Victoria. No part of this publication may be reproduced except as permitted by the Copyright Act 1968 (Cth), to comply with a statutory requirement or pursuant to a written agreement. The information is only valid at the time and in the form obtained from the LANDATA REGD TM System. None of the State of Victoria, its agents or contractors, accepts responsibility for any subsequent publication or reproduction of the information.

The Victorian Government acknowledges the Traditional Owners of Victoria and pays respects to their ongoing connection to their Country, History and Culture. The Victorian Government extends this respect to their Elders, past, present and emerging.

REGISTER SEARCH STATEMENT (Title Search) Transfer of Land Act 1958

VOLUME 10224 FOLIO 394

Security no : 124094601930T
Produced 23/12/2021 09:27 AM

LAND DESCRIPTION

Land in Plan of Consolidation 153719.
PARENT TITLE Volume 09499 Folio 800
Created by instrument T461866C 13/12/1994

REGISTERED PROPRIETOR

Estate Fee Simple
Sole Proprietor
DORCAS ST DEVELOPMENT PTY LTD of LEVEL 5 420 ST KILDA ROAD MELBOURNE VIC
3004
AU008622B 03/02/2021

ENCUMBRANCES, CAVEATS AND NOTICES

MORTGAGE AU772086H 03/09/2021
AUSTRALIA AND NEW ZEALAND BANKING GROUP LTD

Any encumbrances created by Section 98 Transfer of Land Act 1958 or Section 24 Subdivision Act 1988 and any other encumbrances shown or entered on the plan or imaged folio set out under DIAGRAM LOCATION below.

DIAGRAM LOCATION

SEE CP153719 FOR FURTHER DETAILS AND BOUNDARIES

ACTIVITY IN THE LAST 125 DAYS

NUMBER		STATUS	DATE
AU772085K (E)	DISCHARGE OF MORTGAGE	Registered	03/09/2021
AU772086H (E)	MORTGAGE	Registered	03/09/2021

-----END OF REGISTER SEARCH STATEMENT-----

Additional information: (not part of the Register Search Statement)

Street Address: 11-17 DORCAS STREET SOUTH MELBOURNE VIC 3205

ADMINISTRATIVE NOTICES

NIL

eCT Control 19207U CORRS CHAMBERS WESTGARTH
Effective from 03/09/2021

DOCUMENT END

Delivered from the LANDATA® System by GlobalX Pty Ltd

CP153719

**PLAN OF CONSOLIDATION OF
 CROWN ALLOTMENTS 21, 22 & 23,
 SECTION 59
 CITY OF SOUTH MELBOURNE
 PARISH OF MELBOURNE SOUTH
 COUNTY OF BOURKE**



CP153719

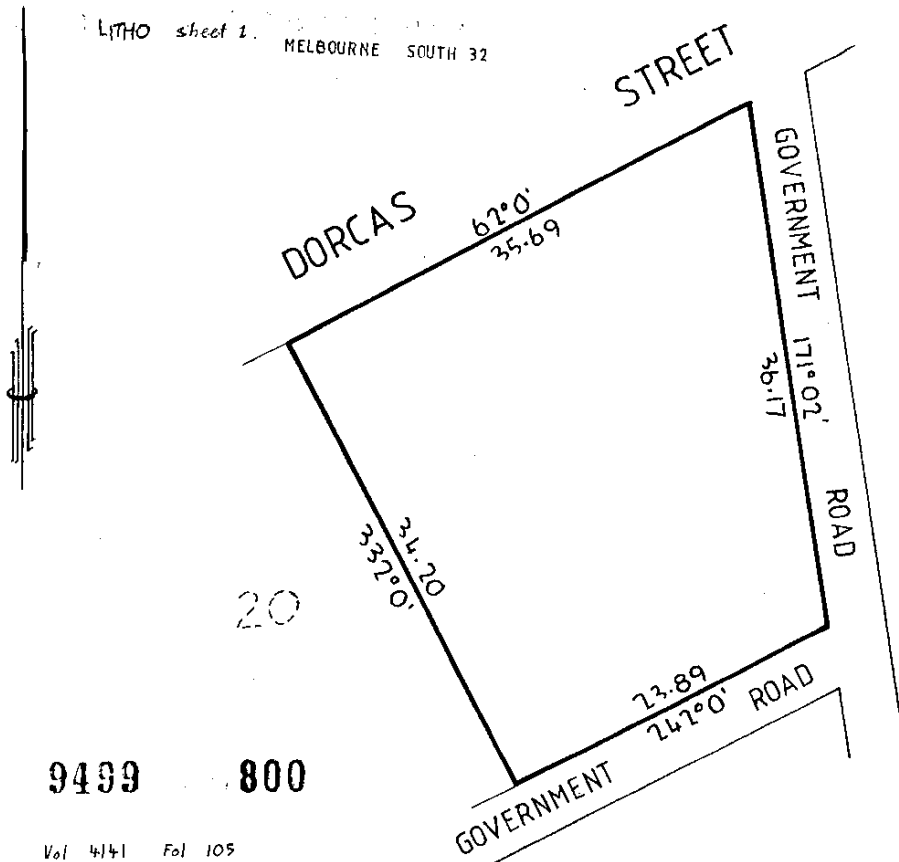

APPROVED

Vol 4141 Fol 105
Vol 8899 Fol 600

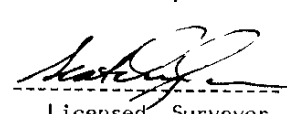
CONSENT OF COUNCIL	SURVEYORS CERTIFICATION
<p>This Plan of Consolidation was approved by the Council of the City of South Melbourne on 7th September, 1981, and has been sealed pursuant to Section 569AB of the Local Government Act.</p> <p>As witness whereof the) corporate Seal of the) Mayor, Councillors and) Citizens of the City of) South Melbourne was) affixed hereto this) Eighth day of September) 1981 in the presence of)</p> <p style="margin-left: 100px;"> Mayor <i>[Signature]</i> Councillor <i>[Signature]</i> Chief Executive Officer and Town Clerk <i>[Signature]</i> </p>	<p>I certify that this plan has been made by me or under my immediate supervision, accords with Title and is mathematically correct.</p> <p style="text-align: center;">  _____ Licensed Surveyor </p> <p>Date <u>14/7/1981</u></p>