

FEIGL & NEWELL PTY. LTD. A.B.N. 91 155 326 195

Professional Title Searchers

ESTABLISHED 1968

Consultant for:

SEMI & LOCAL GOVERNMENT
SURVEYORS
PLANNERS
VALUERS
SOLICITORS
ENVIROSCIENTISTS

Searchers of:

T.L.A. TITLES
GENERAL LAW
CROWN LANDS
SURVEY INFORMATION
CORPORATE AFFAIRS
COVENANT BENEFICIARIES

Date: 8/03/2023

YOUR REF: 119807-00504 MOUBRAY STREET

The land highlighted on the attached plans is a Government Road under the authority of the local council.

Yours sincerely,

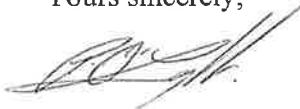

Peter O'Loughlin

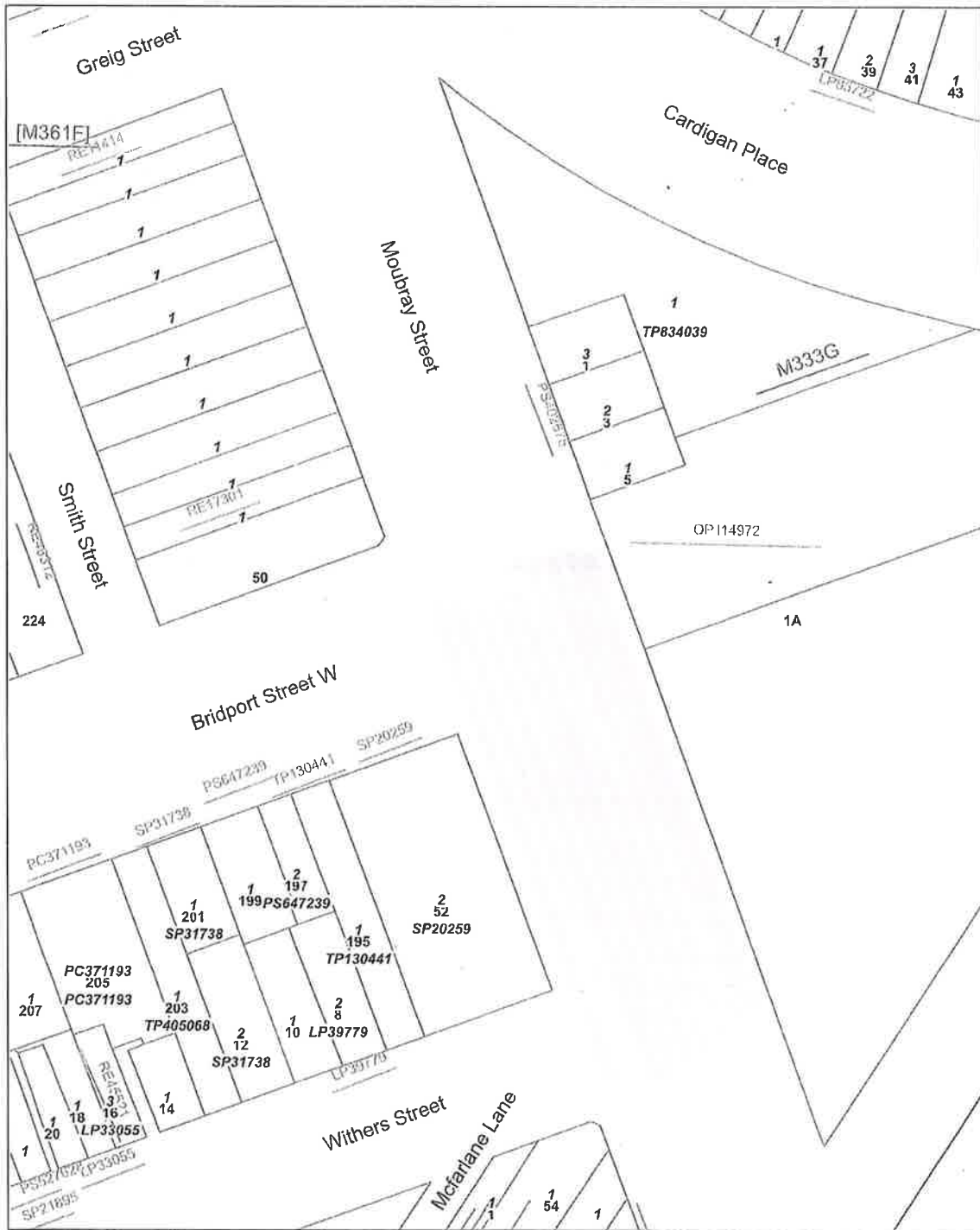

Data Source: Vicmap Property

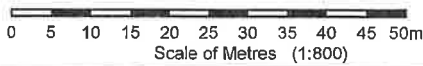

MGA Zone 55
 Melways- 2J K7 (ed.42) Vicroads- 437 A10 (ed.8)
 Created 09:20 AM on Mar 8, 2023

Co-ordinates of Plot Corners
 NW 319705,5809846
 SW 319709,5809667
 MGA Zone 55

WARNING:
 No warranty is given as to the accuracy or completeness of this map.
 Dimensions are approximate.
 For property dimensions, undertake a Title search.

Co-ordinates of Plot Corners
 NE 319849,5809849
 SE 319853,5809670
 MGA Zone 55

See 195397 for
M.M.W. and Gas
and Fuel Corp.
Requirements.

STATE SCHOOL RESERVE
2 OF 44
ps 5397
Gas 1971.2230

STATE SCHOOL
3 OF 44
Gas 77p.364
RS 5397

SEE SHEET 3.

DPORT

0	Hill	70	70
1	Wickard	70	70
2	J.P. Horridge	70	70
3	Buckhurst	70	70
4	I. Patterson	70	70
5	A. Boyd	70	70
6	A. Boyd	70	70
7	A. Boyd	70	70
8	J. McFarlane	70	70

83

17	W.P. Buckhurst	70	70
18	A. Boyd	70	70
19	A. Boyd	70	70
20	A. Boyd	70	70
21	A. Boyd	70	70
22	A. Boyd	70	70
23	A. Boyd	70	70
24	A. Boyd	70	70
25	A. Boyd	70	70
26	A. Boyd	70	70
27	A. Boyd	70	70
28	A. Boyd	70	70
29	A. Boyd	70	70
30	A. Boyd	70	70

STREET

STREET

STREET

AVENUE

O'CRADY 43B

N 62

22	200	72	30
23	200	73	30
24	200	74	30
25	200	75	30
26	200	76	30
27	200	77	30
28	200	78	30
29	200	79	30
30	200	80	30

